

# SERIES 1

Assembly Instruction Manual

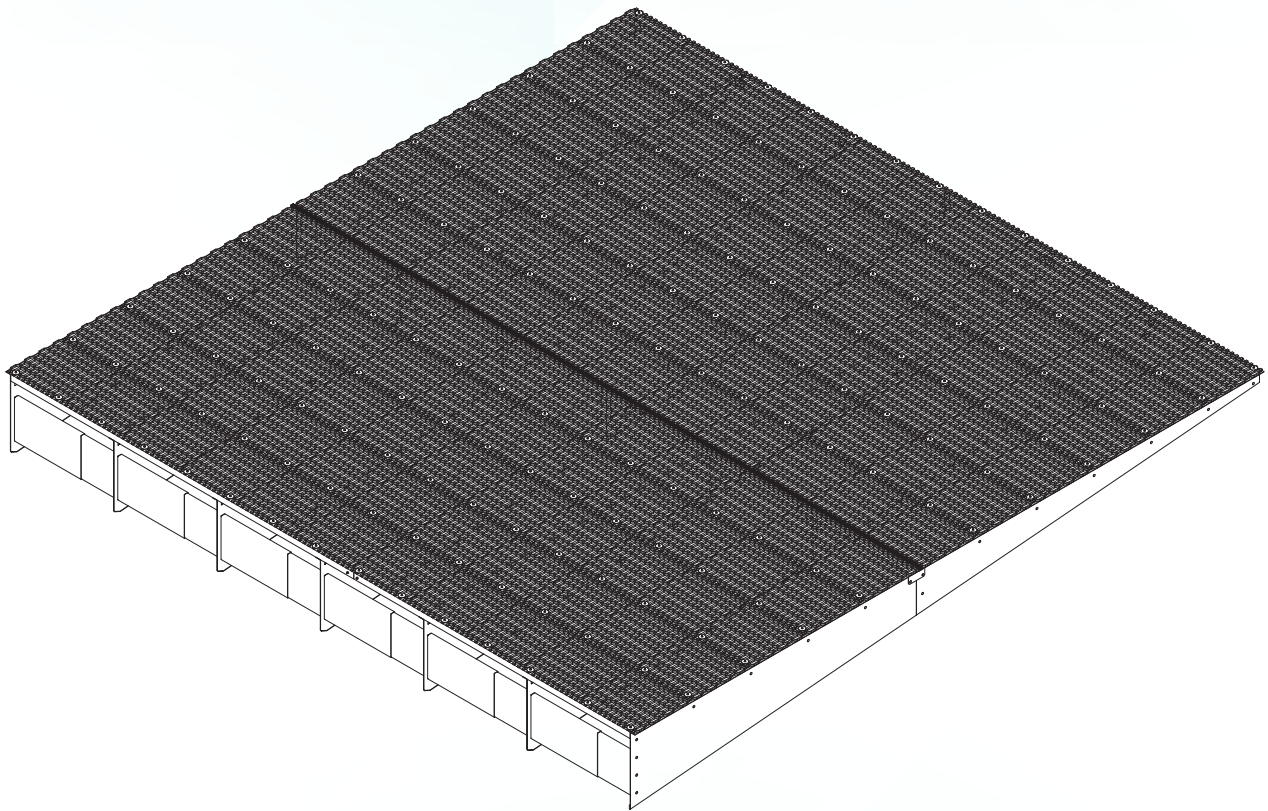

**Con-form**<sup>®</sup>  
**GROUP**  
VE valueengineering™

☎ 1300 882 490

✉ [info@con-formgroup.com.au](mailto:info@con-formgroup.com.au)

# SERIES 1

Con-Form Series 1 Surface Mounted Platforms –  
Ideal For Pitched Metal Deck Roofs.

## Contents

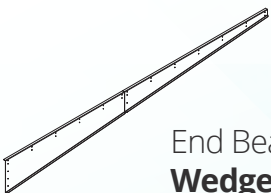
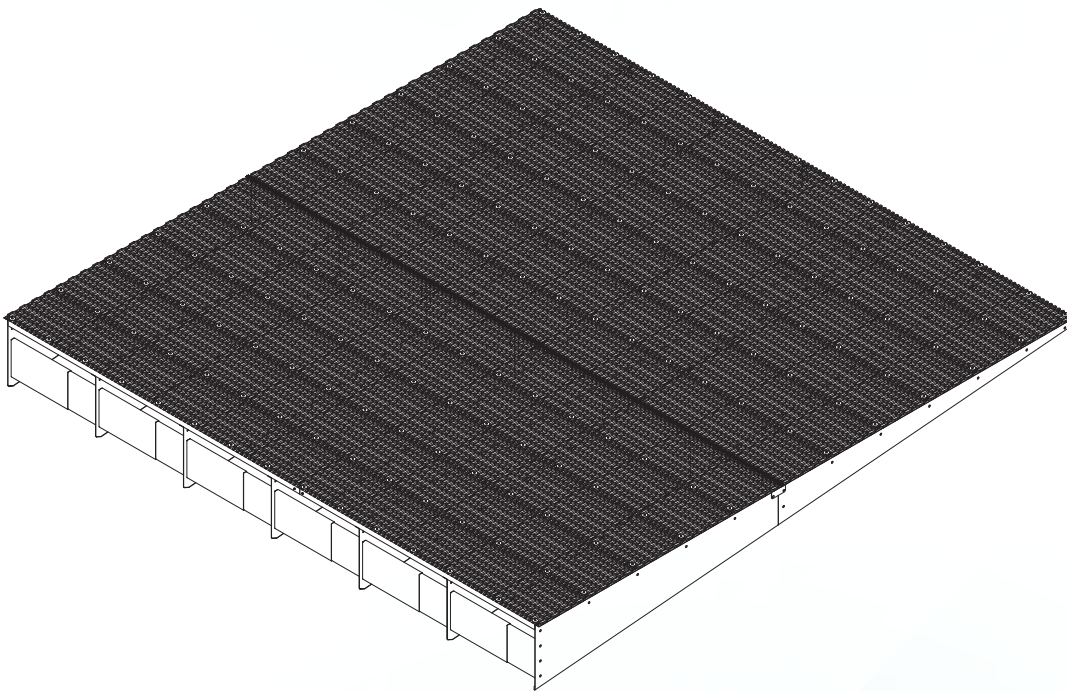

End Beam  
**Wedge Left**



Intermediate  
**Wedge**



End Beam  
**Wedge Right**

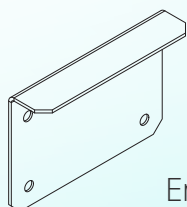

End Beam **Splice**

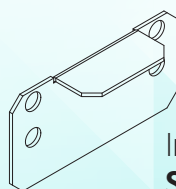

Intermediate  
**Splice**

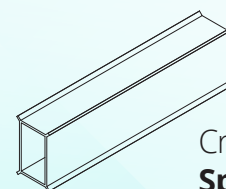

Cross Support  
**Splice**

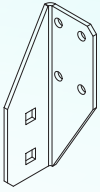

Intermediate  
**Bracket Left**

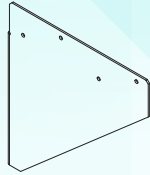

Intermediate  
**Bracing Bracket**



Intermediate  
**Bracket Right**

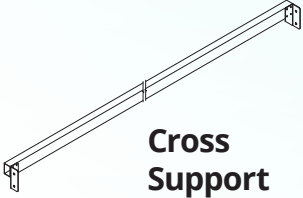

**Cross Support**

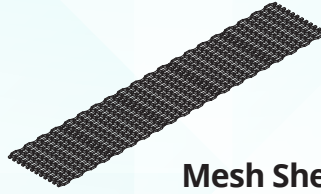

**Mesh Sheet**

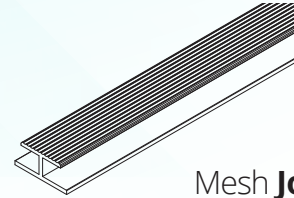

Mesh **Joiner**

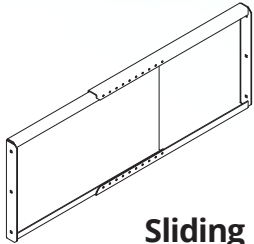

**Sliding Brace**

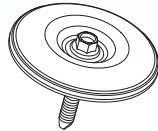

35mm **Tek Screw**  
+ **Hold Down Disc**



**Certification Plate**

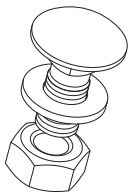

20mm **Bolt Sets**

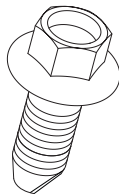

20mm **Tek Screws**

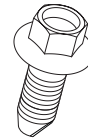

16mm **Tek Screws**

## Tools required

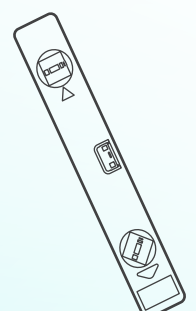
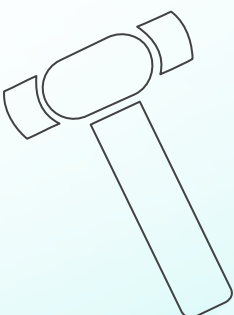
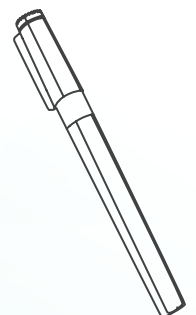
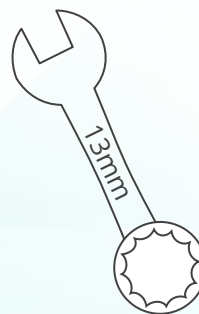
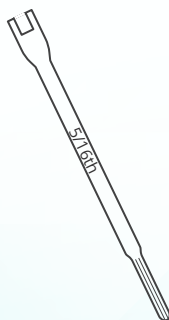



# Assembly

1

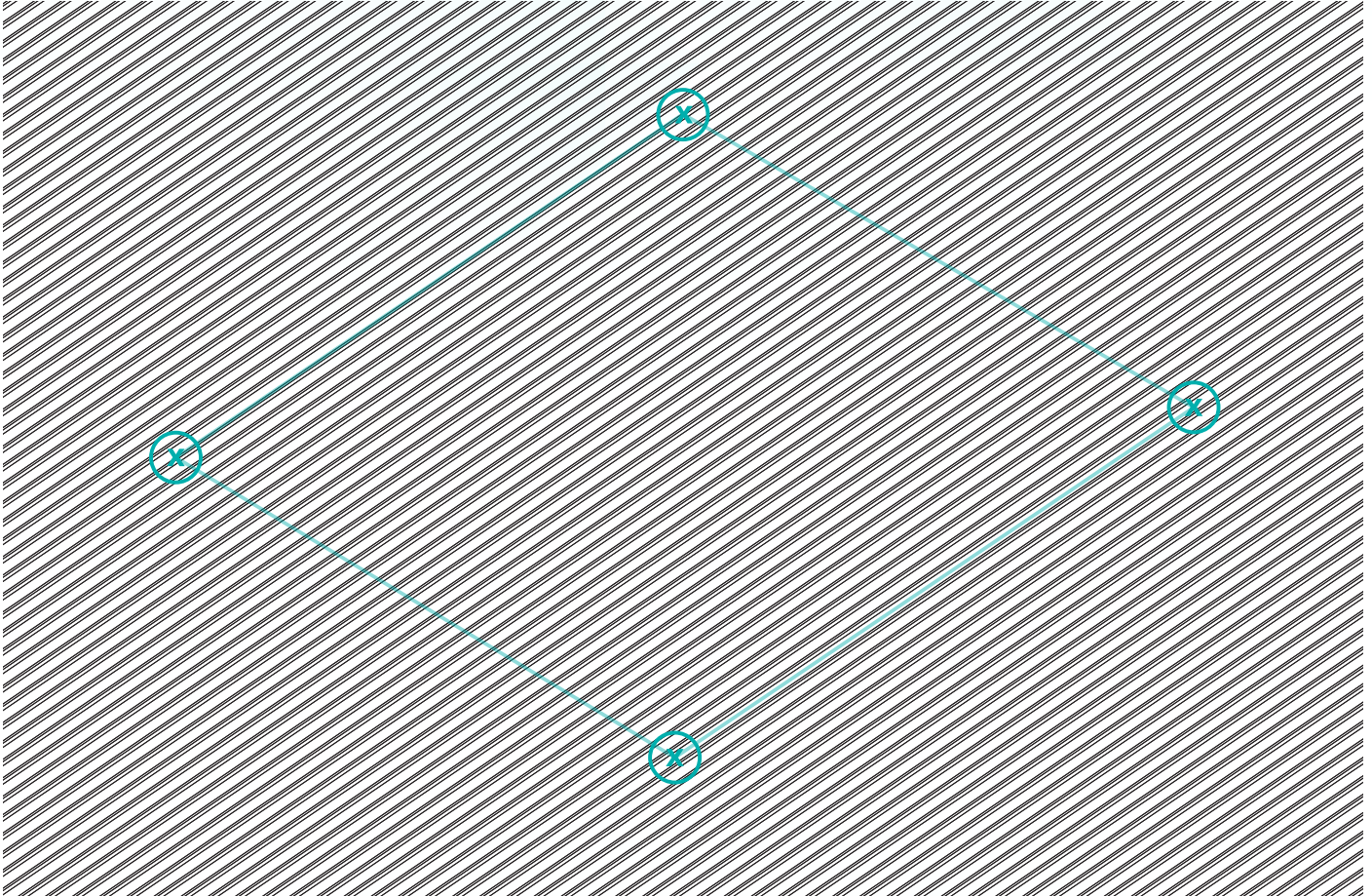

## Assembly description

1. Mark out the four corners of the platform size on the roof where you will place your platform.



2

## Parts required

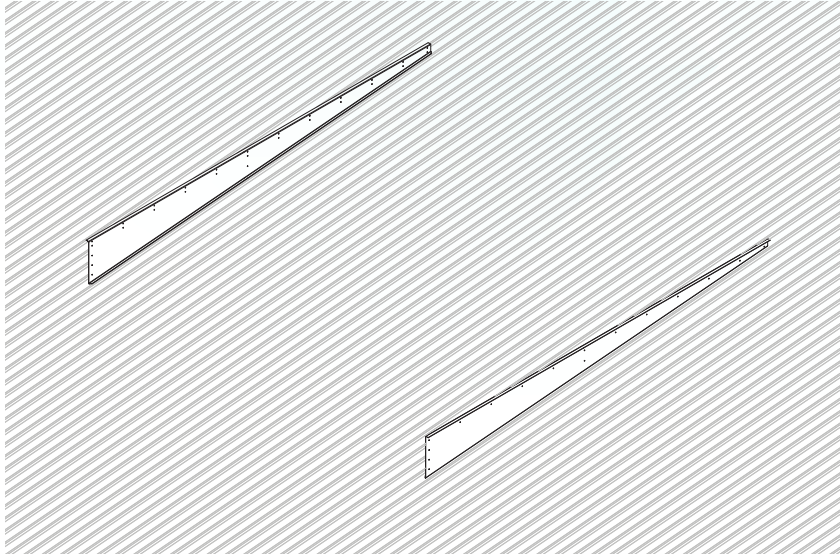

End Beam  
**Wedge Left**

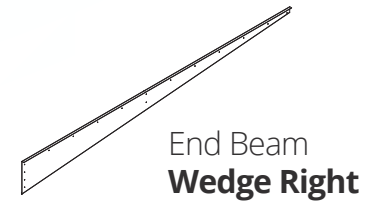

End Beam  
**Wedge Right**

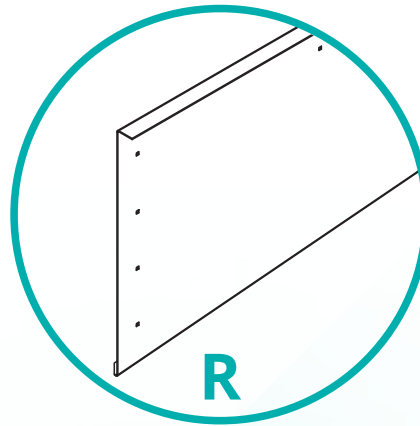
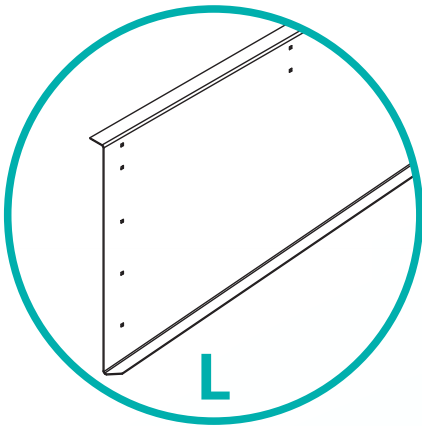

## Assembly description

**2.** Place the **End Beam Wedge Left** and the **End Beam Wedge Right** in the roof pans on the corner marks that you have made. The big end of the Wedge must be down roof. If your wedges have been supplied with VHB tape, leave the red backing tape on the wedges until step 16.

3

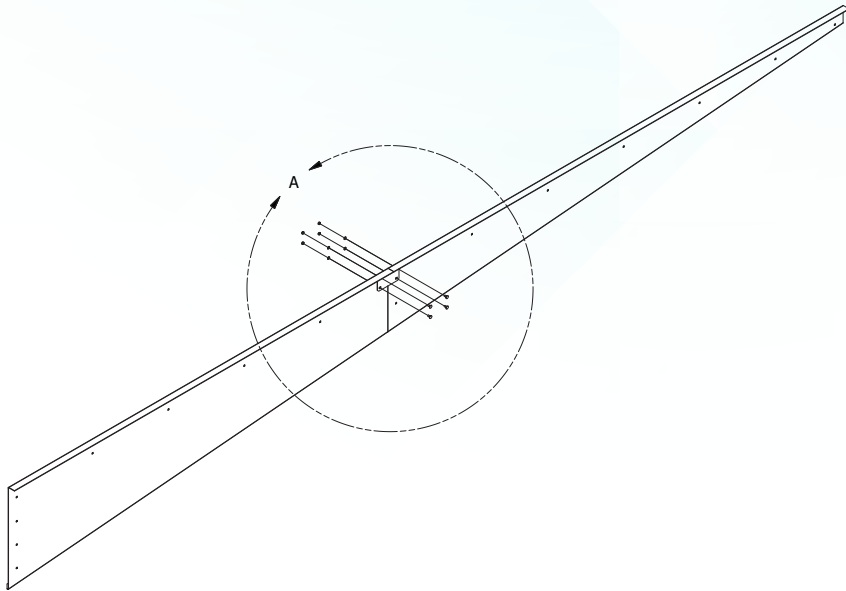

### Parts required

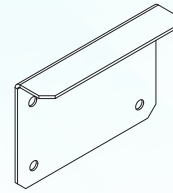

End Beam **Splice**

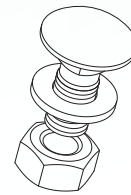

20mm **Bolt Sets**

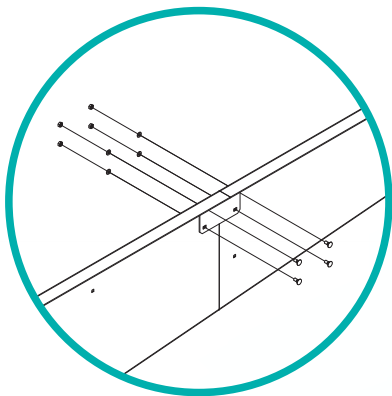

### Assembly description

**3.** If the platform is wider than 6000mm down roof then the **End Beam Wedge Left** and **End Beam Wedge Right** will be in two pieces, these need to be joined together using the **End Beam Splice** and **20mm Bolt Sets** – leave the nuts done up finger tight only.

4

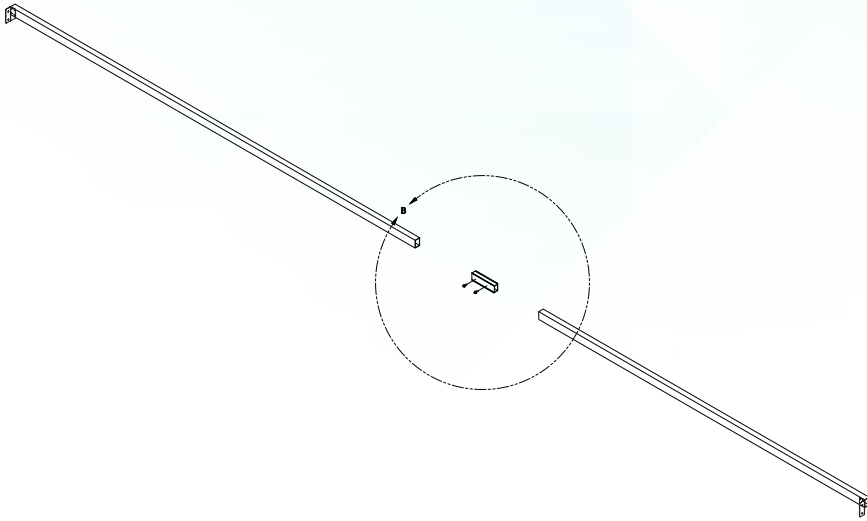

### Parts required

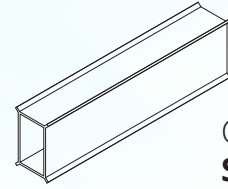

Cross Support  
**Splice**

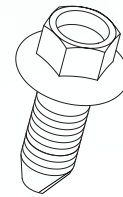

20mm **Tek Screws**

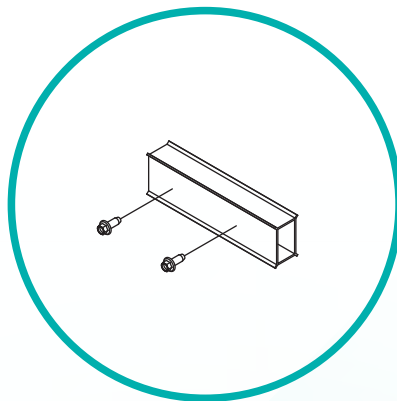
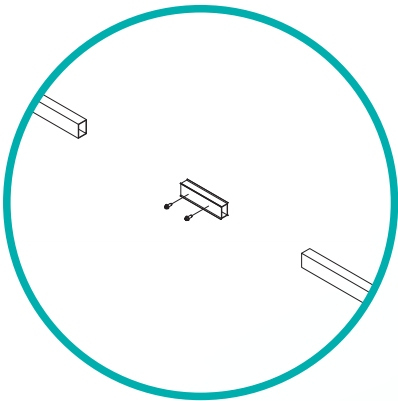

### Assembly description

4. If the platform is longer than 6000mm across roof then the **Cross Supports** will be in 2 pieces, join the pieces of the Cross Support together using **20mm Screws** and the **Cross Support Splice**.



5

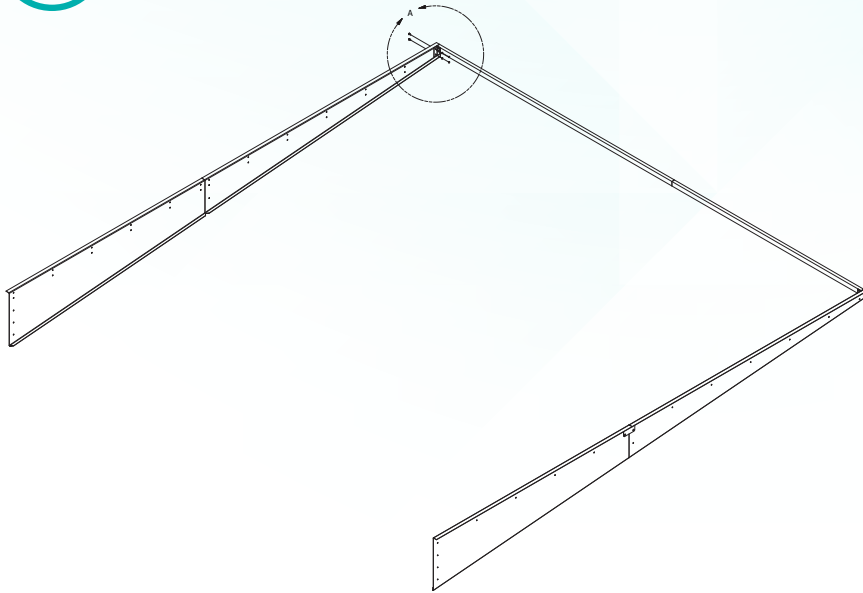

## Parts required

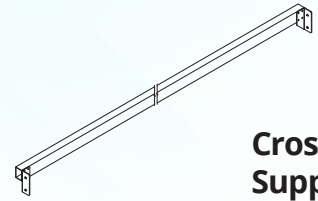

**Cross Support**

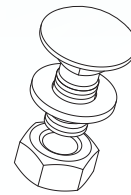

20mm **Bolt Sets**

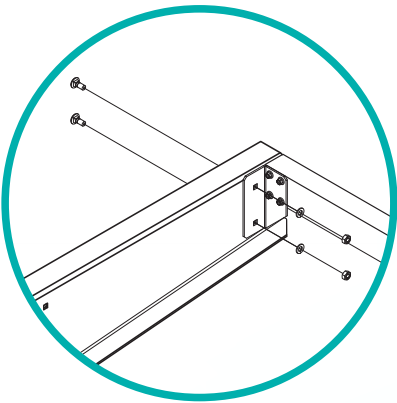

## Assembly description

**5.** Place a **Cross Support** between the End Beam Wedge Left and the End Beam Wedge Right on the smaller (up roof) end of the platform with the brackets facing down roof and bolt in place using **20mm Bolt Sets**.

6

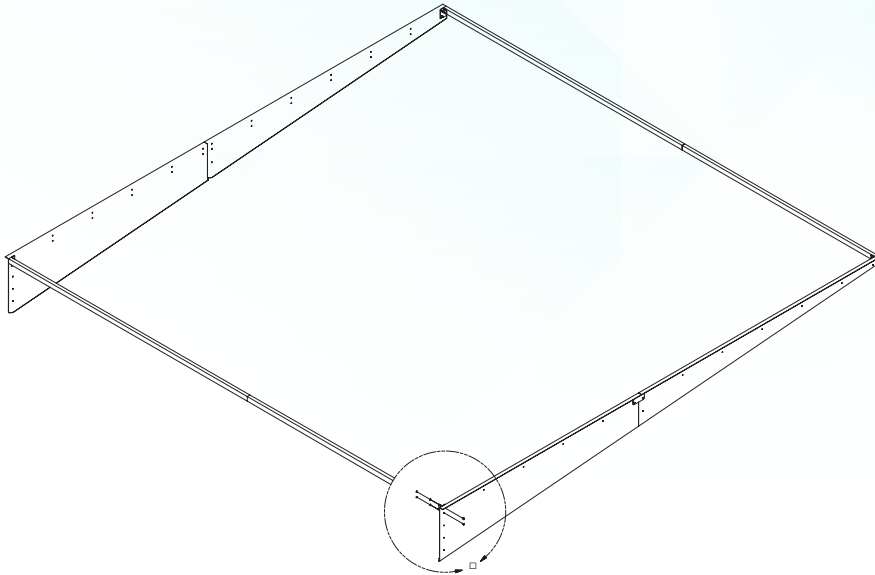

## Parts required

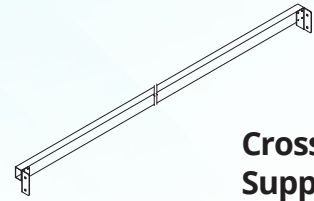

**Cross Support**

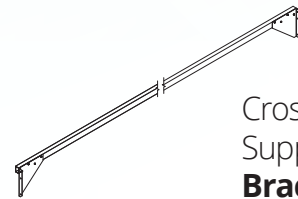

**Cross Support with End Bracing Bracket**

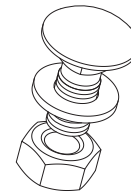

**20mm Bolt Sets**

Or

Or

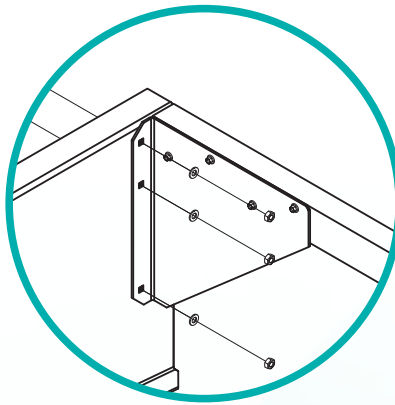
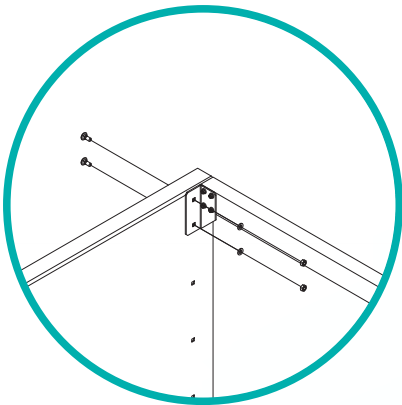

## Assembly description

**6.** Place a **Cross Support** between the **End Beam Wedge Left** and the **End Beam Wedge Right** on the bigger (down roof) end of the platform with the brackets facing up roof and bolt in place using **20mm Bolt Sets**. If the bigger end has three holes then a **Cross Support** with **End Bracing Brackets** must be used.

7

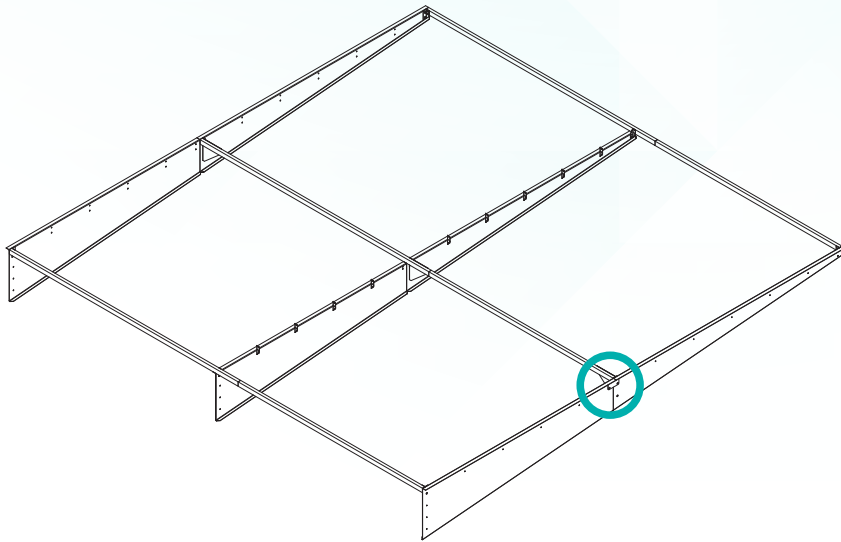

## Parts required

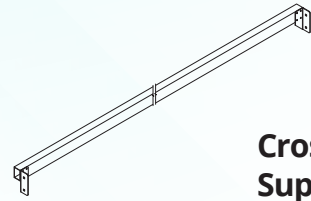

**Cross Support**

Or

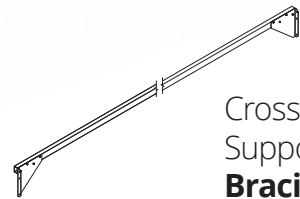

Cross Support with **End Bracing Bracket**

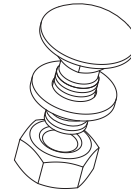

20mm **Bolt Set**

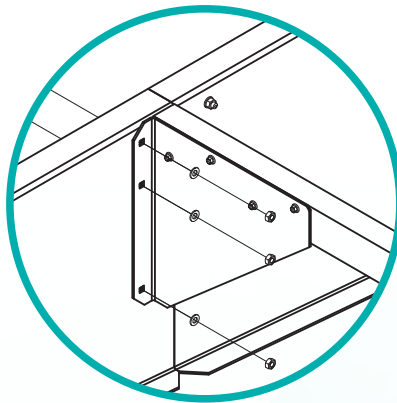
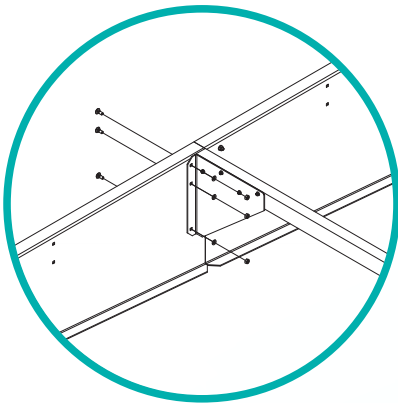

## Assembly description

7. If the platform is wider than 6000mm down roof, place a **Cross Support** between the **End Beam Wedges** in the centre of the platform where the **End Beam Wedges** join. Bolt in place using **20mm Bolt Sets** with the brackets facing up roof. This Cross Support uses the same bolts and bolt holes as the End Beam Splice and connects to the smaller of the two End Beam Wedges at the join. If there are three holes in this location then a **Cross Support with End Bracing Brackets** must be used.



8

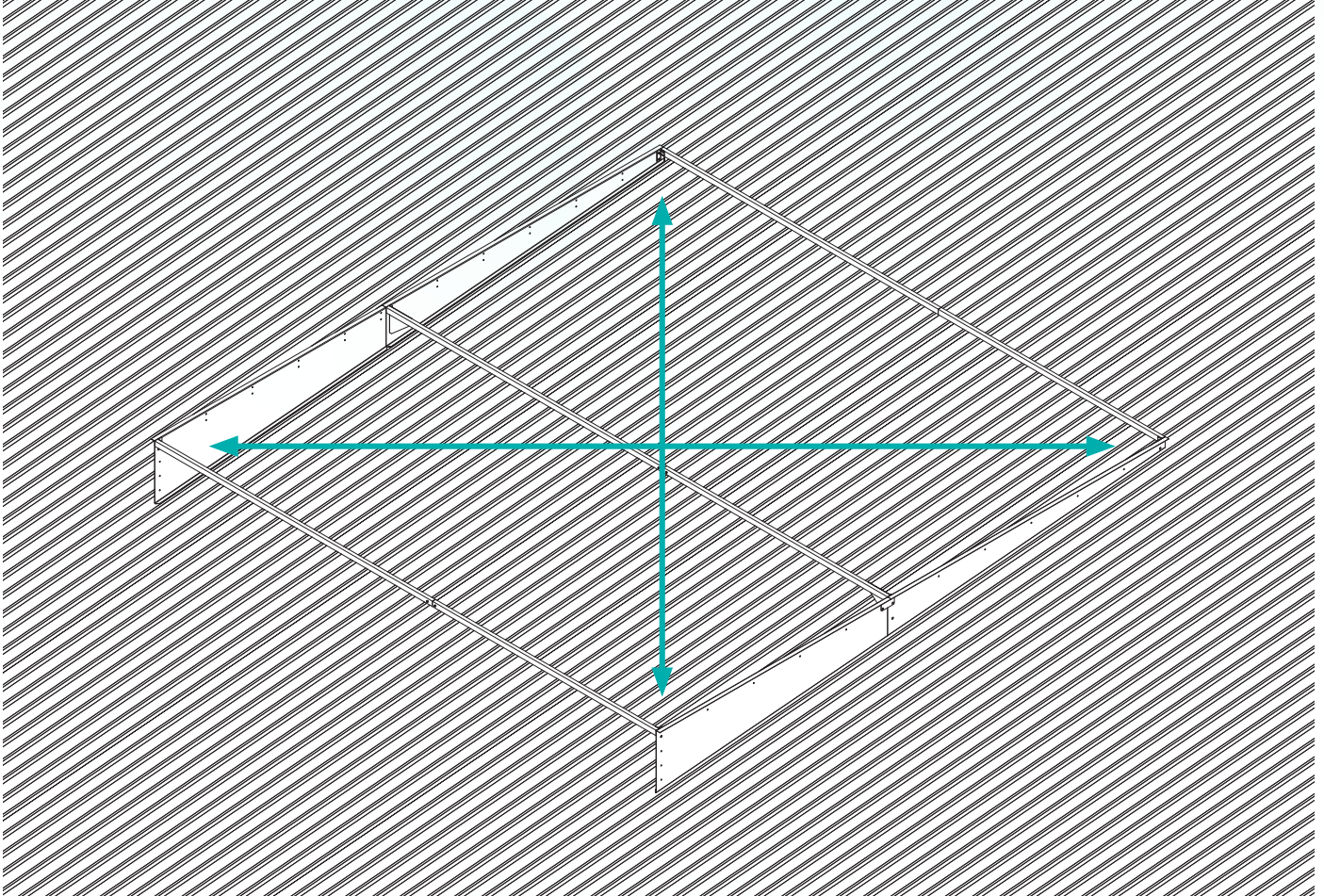

### Assembly description

**8.** Make sure that your **End Beam Wedges** are parallel with the roof sheathing and check and adjust this outer frame for square by measuring between the diagonal points and making the two distances the same.

9

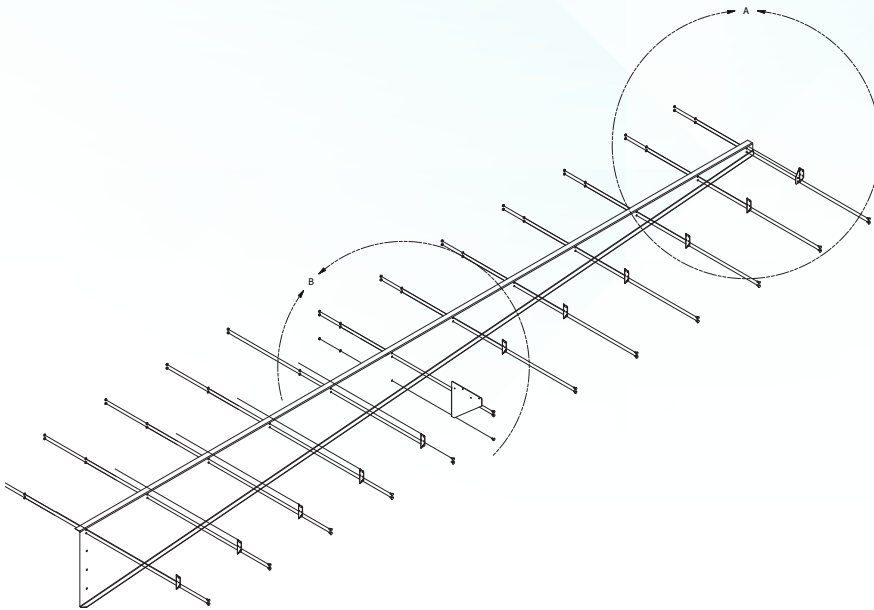

## Parts required

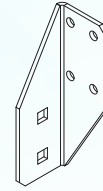

Intermediate  
**Bracket Left**

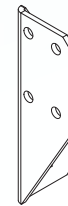

Intermediate  
**Bracket Right**

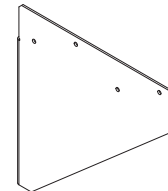

Or

Intermediate  
**Bracing Bracket**

A

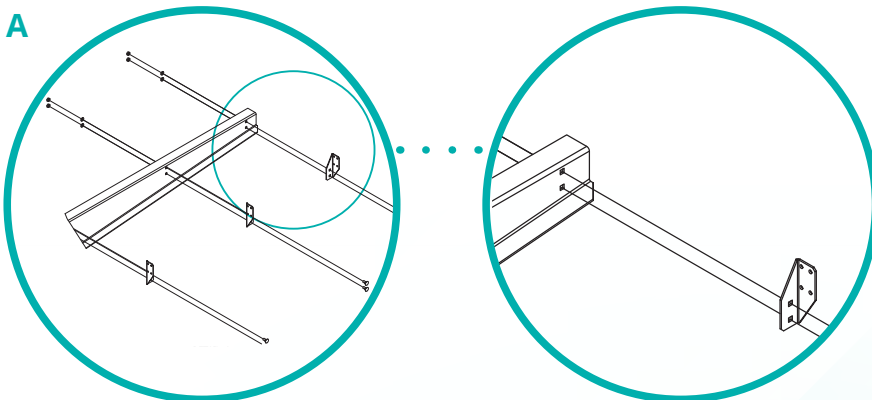

B

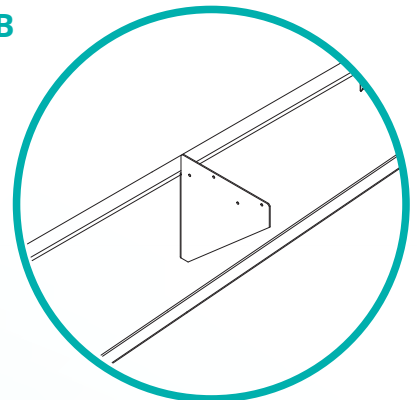

## Assembly description

**9.** Prepare each of the **Intermediate Wedges** by bolting an **Intermediate Bracket Left** to the smallest end and an **Intermediate Bracket Right** to each of the rest of the locations. If any of the locations have three holes then an **Intermediate Bracing Bracket** must be used.

10

## Parts required

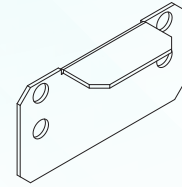

Intermediate  
**Splice**

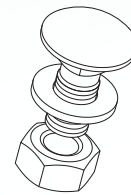

20mm **Bolts Sets**

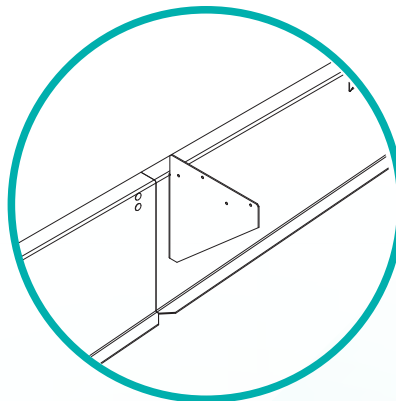
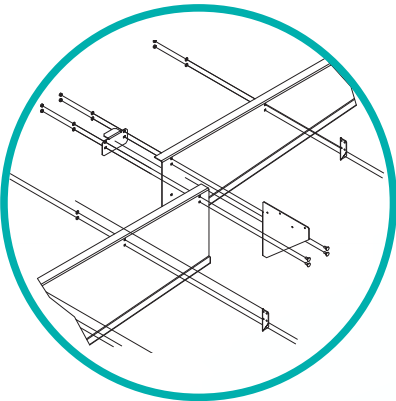
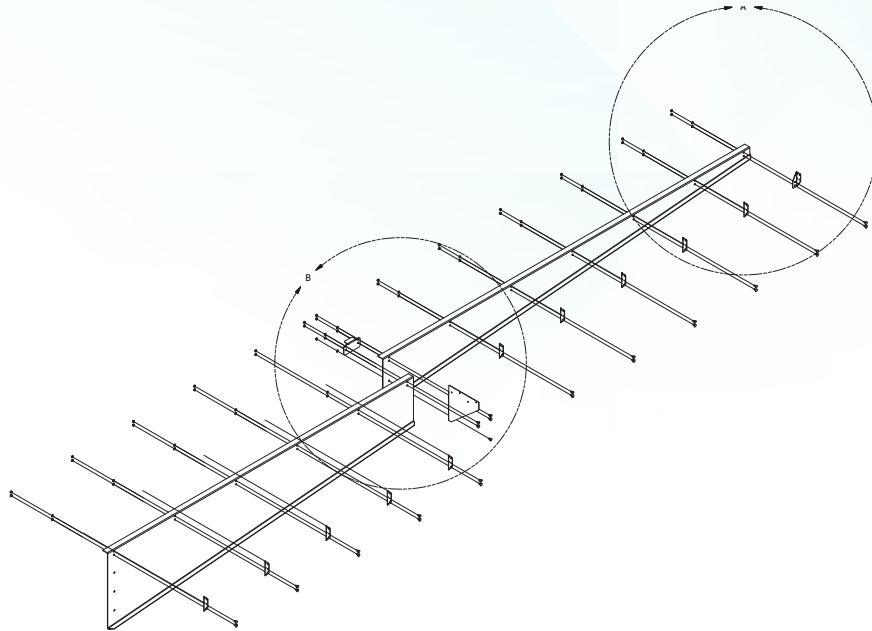

## Assembly description

**10.** If the platform is wider than 6000mm down roof, the **Intermediate Wedges** will be in two pieces, these need to be joined together using the **Intermediate Splice** and **20mm Bolts Sets**. If there are three holes present, an **Intermediate Bracing Bracket** must be used. This bracket uses the same bolts and bolt holes as the Intermediate Splice, if the three holes are located at the join in the Intermediate Wedges.



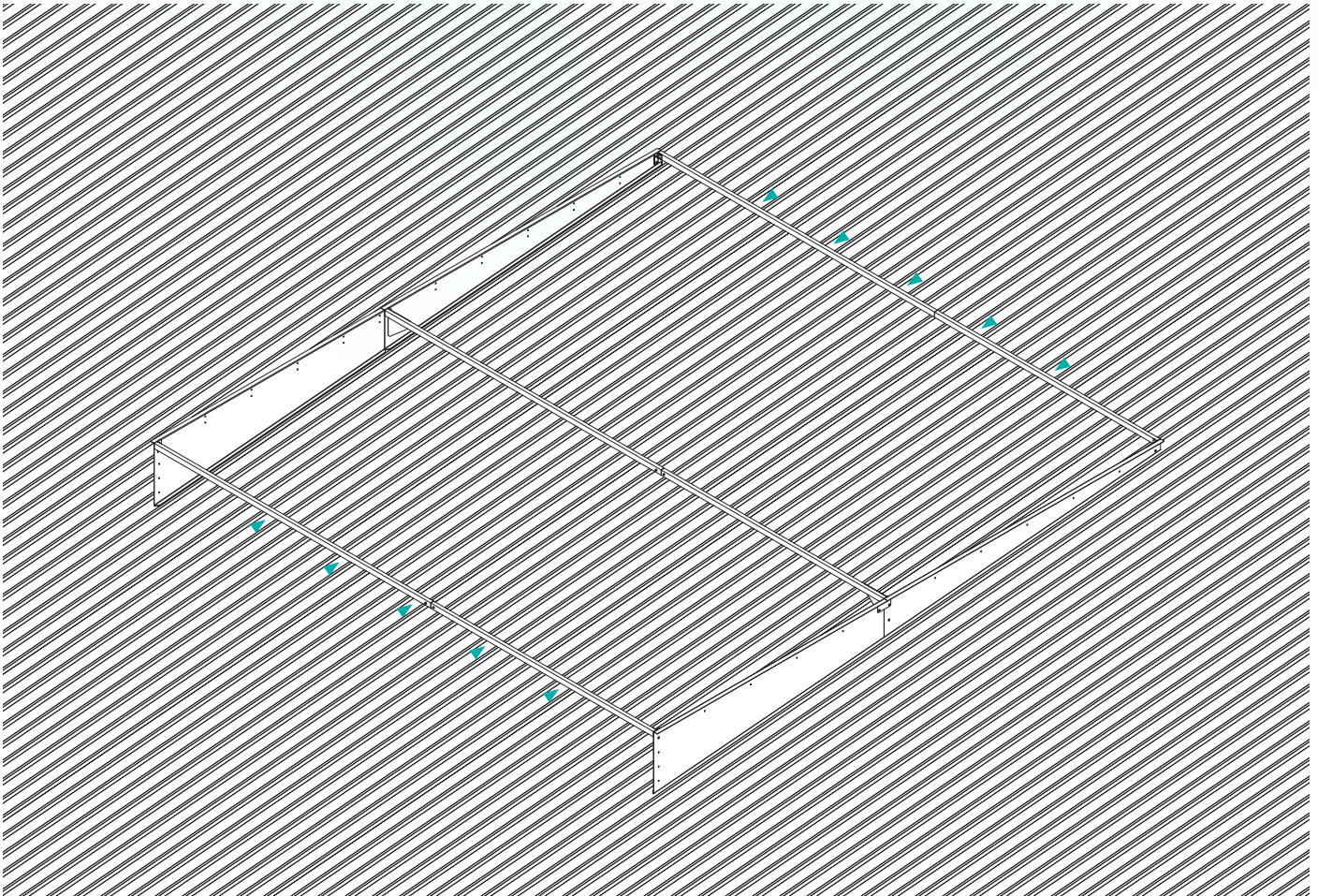

## Assembly description

**11.** Mark the positions of the **Intermediate Wedges** on both **Cross Supports** by dividing the length of the platform by the number of Intermediate Wedges + 1. The distance between your marks should not be greater than 1200mm.

12

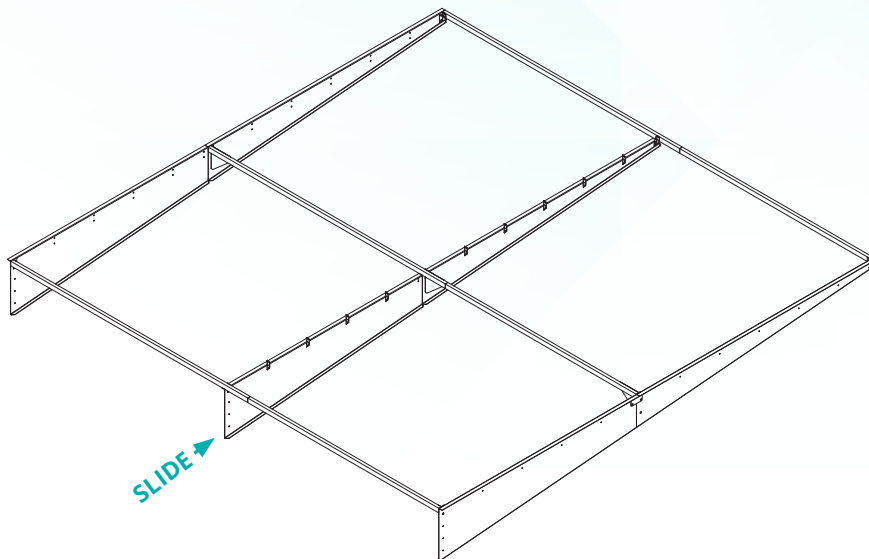

## Parts required



**Intermediate Wedge**

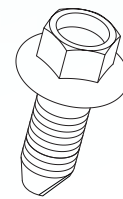

20mm **Tek Screws**

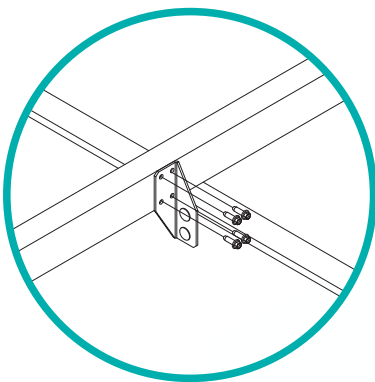

## Assembly description

**12.** Slide in one prepared **Intermediate Wedge** from the high side of the platform and stand in position on the marks you have made as close to the centre of the platform as possible and between the **Cross Supports** and fix in place using **20mm Tek Screws**. This will stop the Cross Supports sagging and allow you to put the rest of the Intermediate Wedges in easily.

13

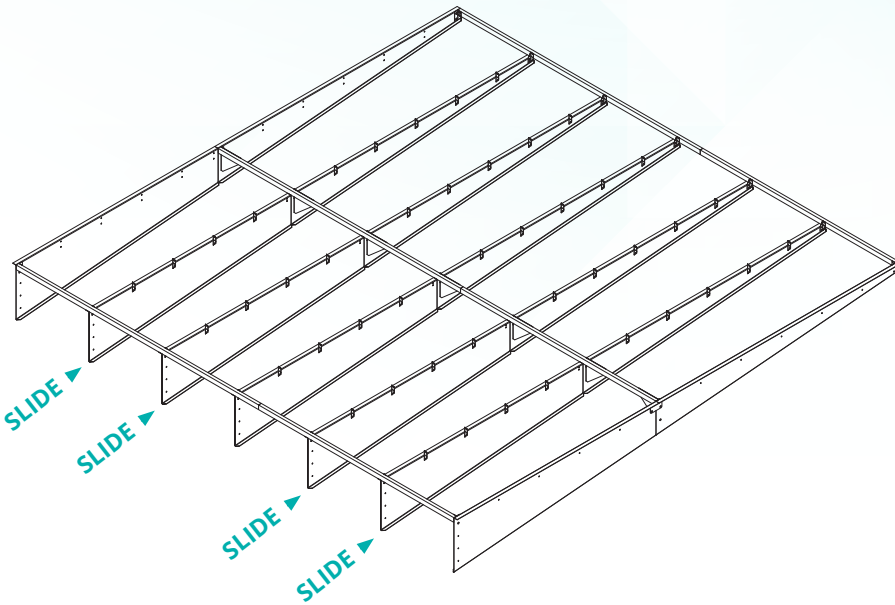

## Parts required

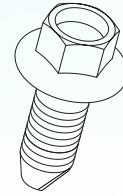

20mm **Tek Screws**

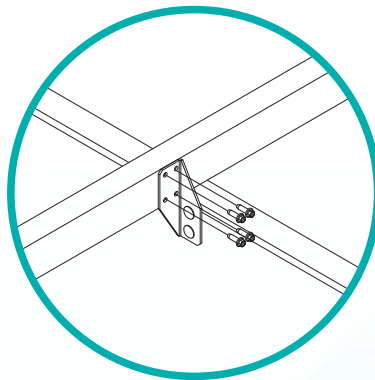
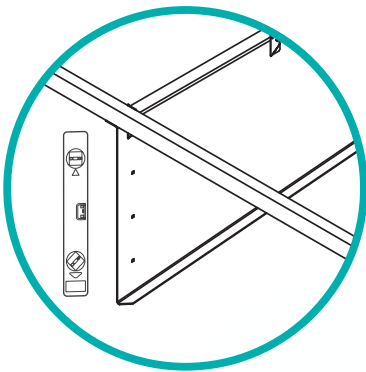

## Assembly description

**13.** Slide in the rest of the prepared **Intermediate Wedges** from the high side of the platform and stand up on the marks you have made, ensuring that they are placed in a pan, vertical, and parallel with the roof sheeting and fix in place using **20mm screws**.



14

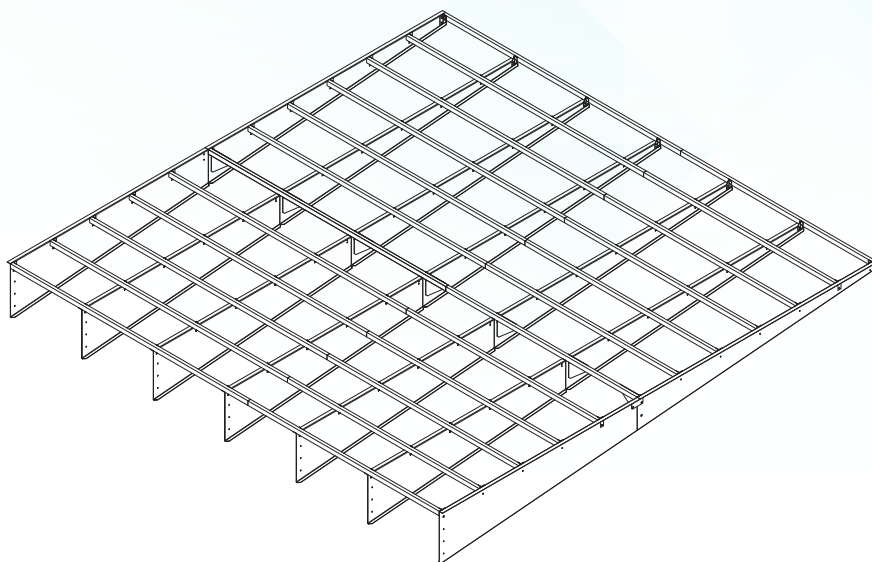

## Parts required

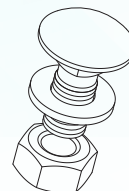

20mm **Bolt Sets**

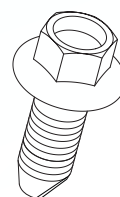

20mm **Tek Screws**

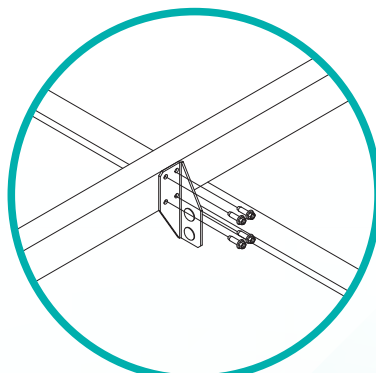
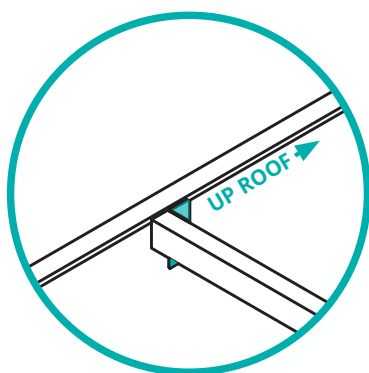

## Assembly description

**14.** Place all the rest of the **Cross Supports** in their positions with the brackets facing up roof and fix to the **End Beam Wedges** using **20mm Bolt Sets** and to the **Intermediate Brackets Right** using **20mm Tek screws**.

15

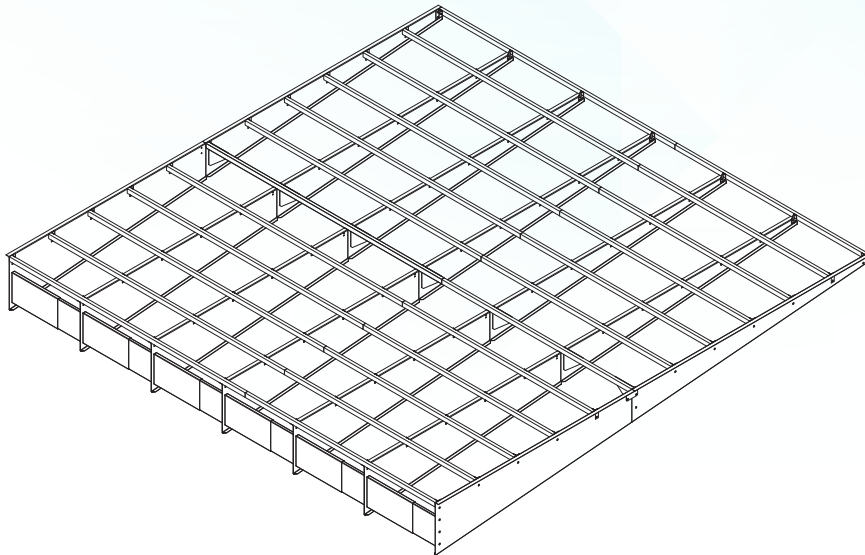

## Parts required

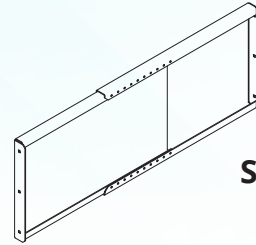

Sliding Brace

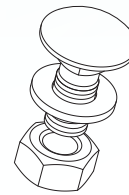

20mm Bolt Set

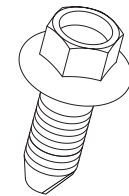

20mm Tek Screws

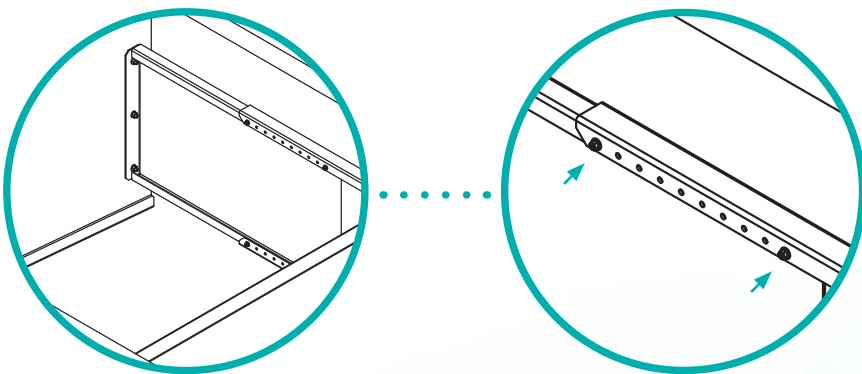

## Assembly description

**15.** If the **End Beam Wedges** are more than 600mm high then each of the wedges will have an additional three holes and **Sliding Braces** must be fixed between each of the Wedges using **20mm Bolt Sets** to join them to the Wedges and **20mm screws** to lock the length of the Sliding Braces.

16

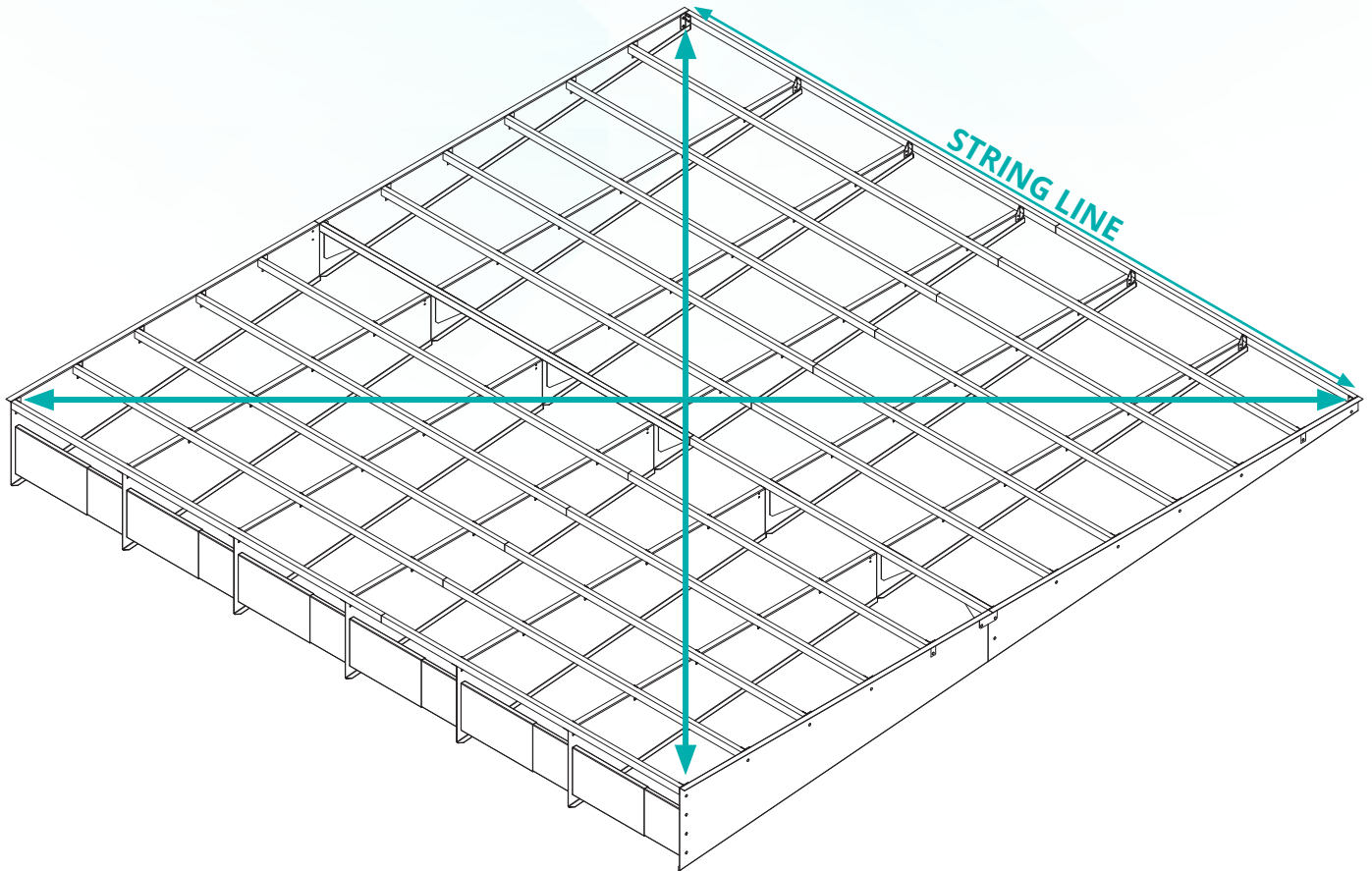

## Assembly description

**16.** Check the complete frame, ensuring all bolts and screws are in place and tight. Check for square using the platform's diagonal measurements and check that the frame is straight along the length by using a string line. If VHB tape is present, remove the red backing tape to fix the wedges to the roof, only once the platform is in its final and correct position. Note, that once affixed, you will not be able to remove the wedges from the roof.



17

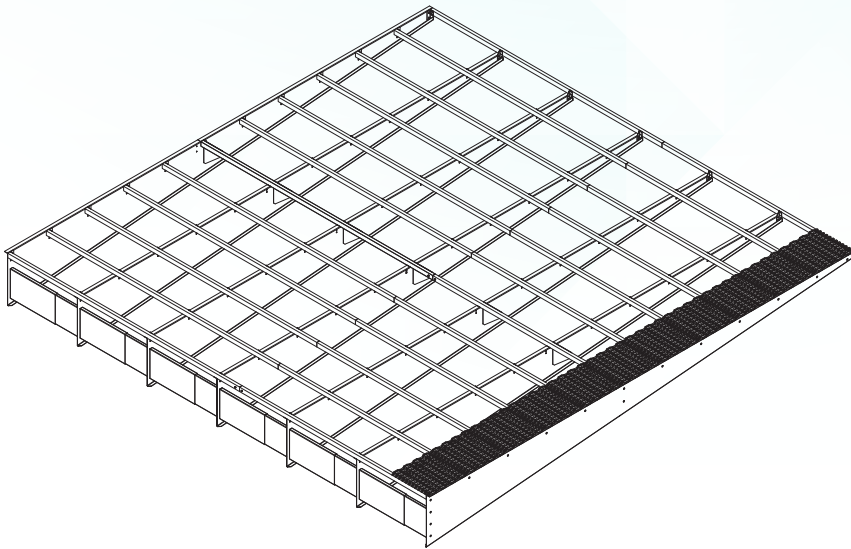

## Parts required

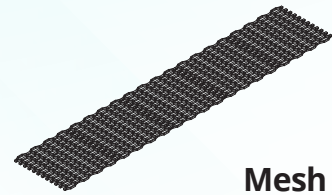

Mesh Sheet

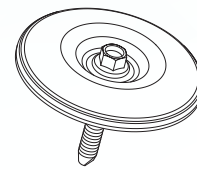

35mm **Tek Screw**  
Hold Down **Disc**

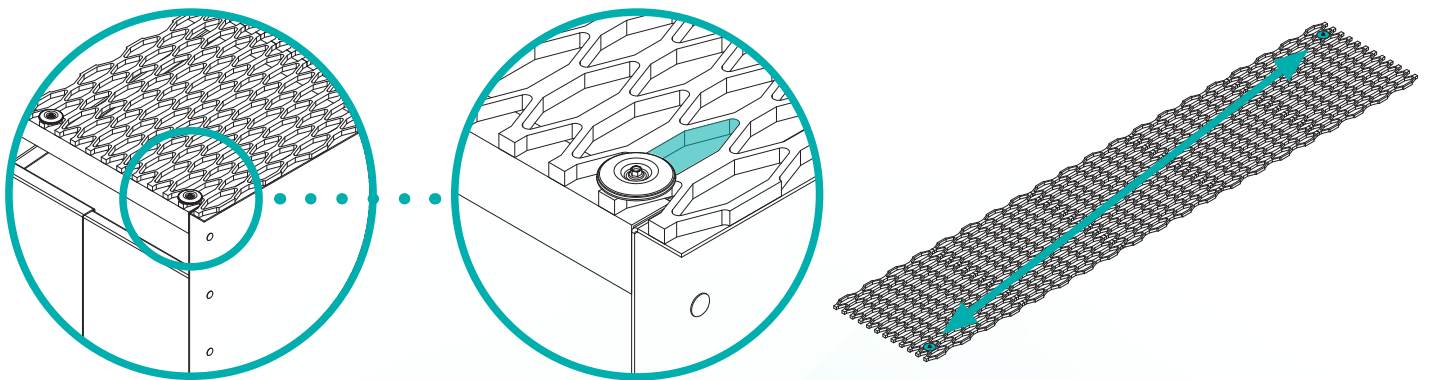

## Assembly description

**17.** Place the first **Mesh Sheet** across the **Cross Supports**, keeping it flush with the **End Beam Wedge** and flush with the end Cross Support, fix it to the Cross Supports on diagonal corners only, using a **35mm Tek Screw** and a **Hold Down Disc** in the second full diamond of the Mesh sheet.

---

18

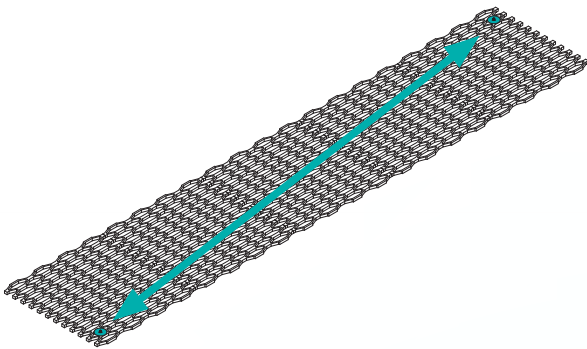
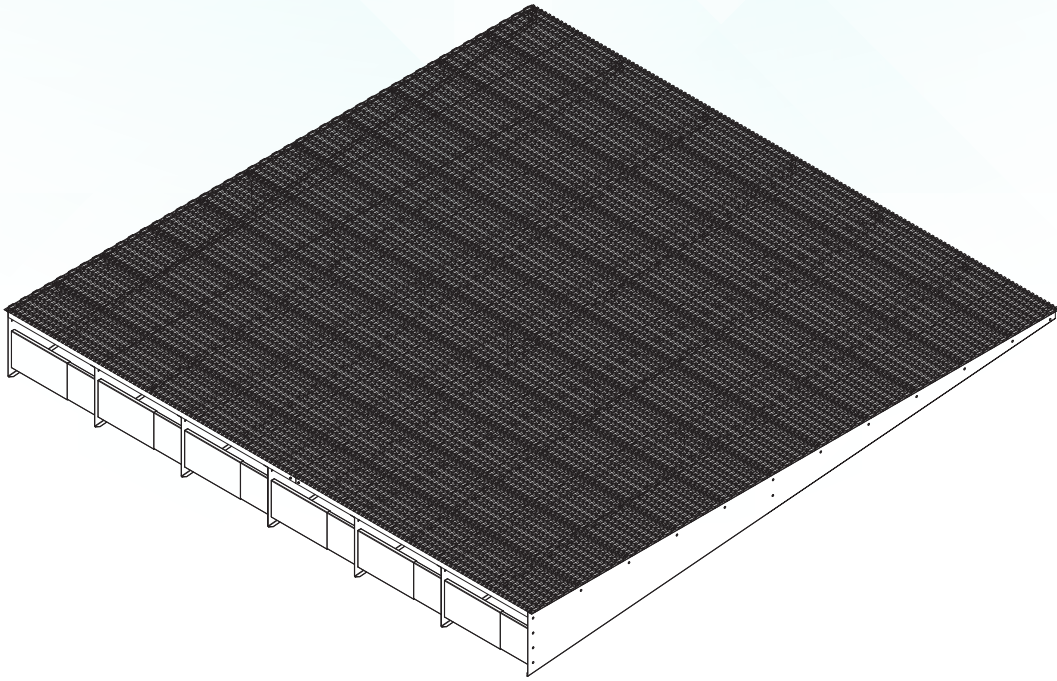

---

### Assembly description

**18.** Place the rest of the sheets of **Mesh** down beside each other and fix down in diagonal corners only as you go, keeping the ends of the sheets flush with the end **Cross Support**, and ensure the sheets are placed tightly and do not creep.

19

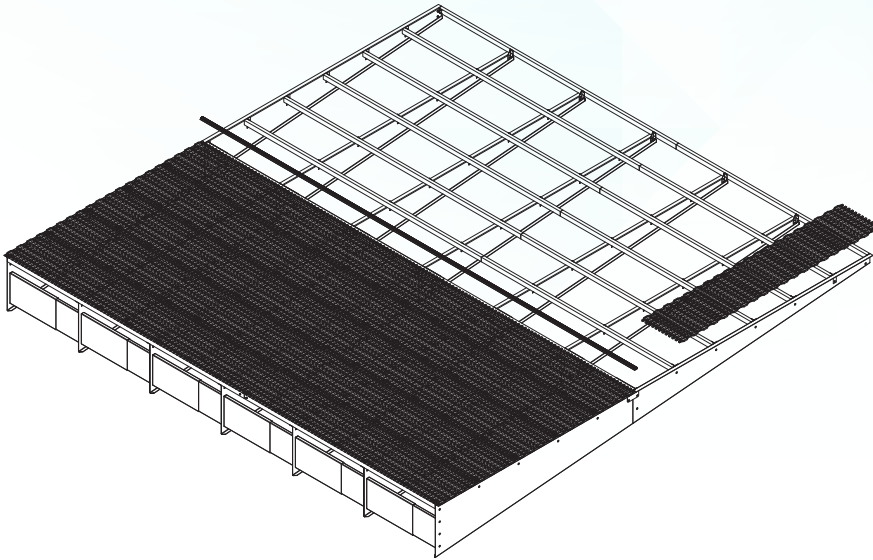

## Parts required

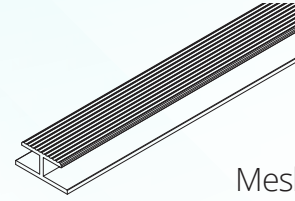

Mesh Joiner

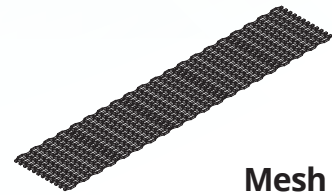

Mesh Sheet

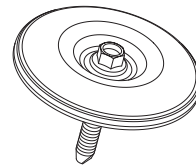

35mm Tek Screw  
Hold Down Disc

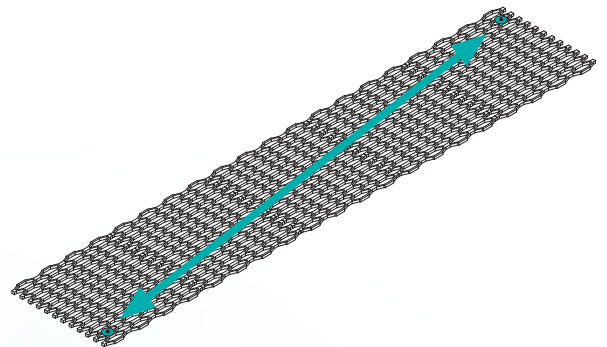
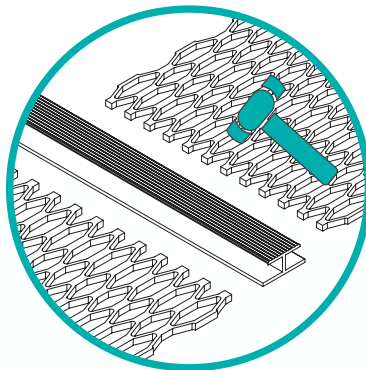
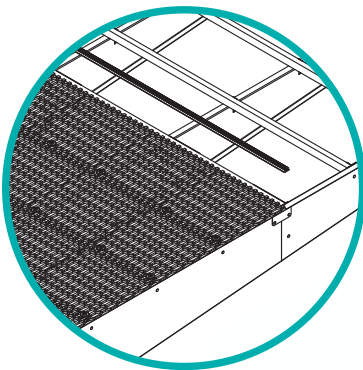

## Assembly description

**19.** If the platform is wider than 6000mm down roof then there will be two rows of **Mesh** joined together with a **Mesh Joiner**, fix the first row of Mesh sheets down as above, then using a rubber mallet tap the Mesh Joiner over the sheet ends. Lay the second row of Mesh sheets by placing the end of each sheet of Mesh into the Mesh Joiner as you go and fix down in diagonal locations.



20

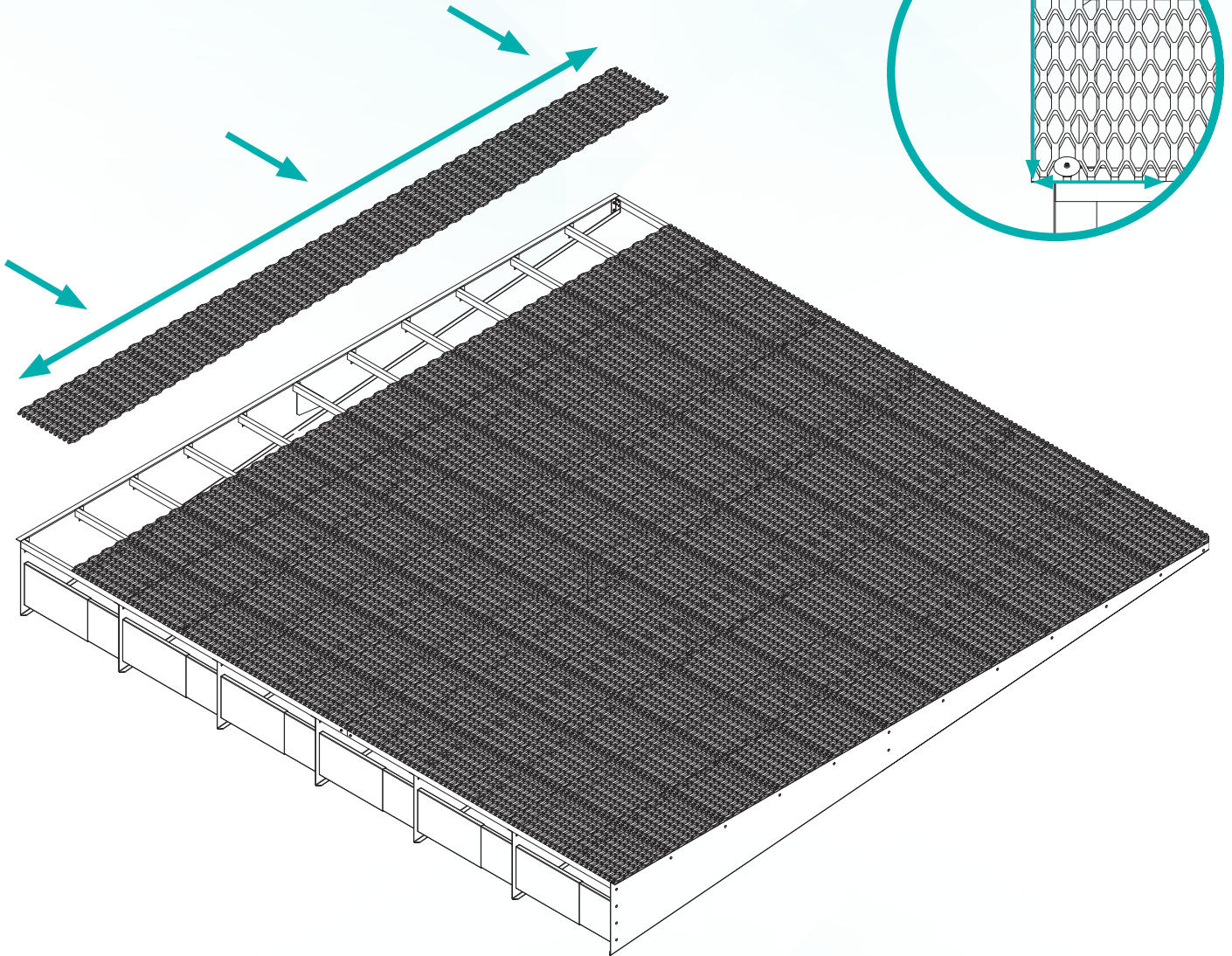

## Assembly description

**20.** When you fix the last **Mesh Sheet** down make sure it is running parallel with the End Beam Wedge and if not adjust the sheets of Mesh by unscrewing the relevant screws and creeping the sheets of Mesh to suit.



21

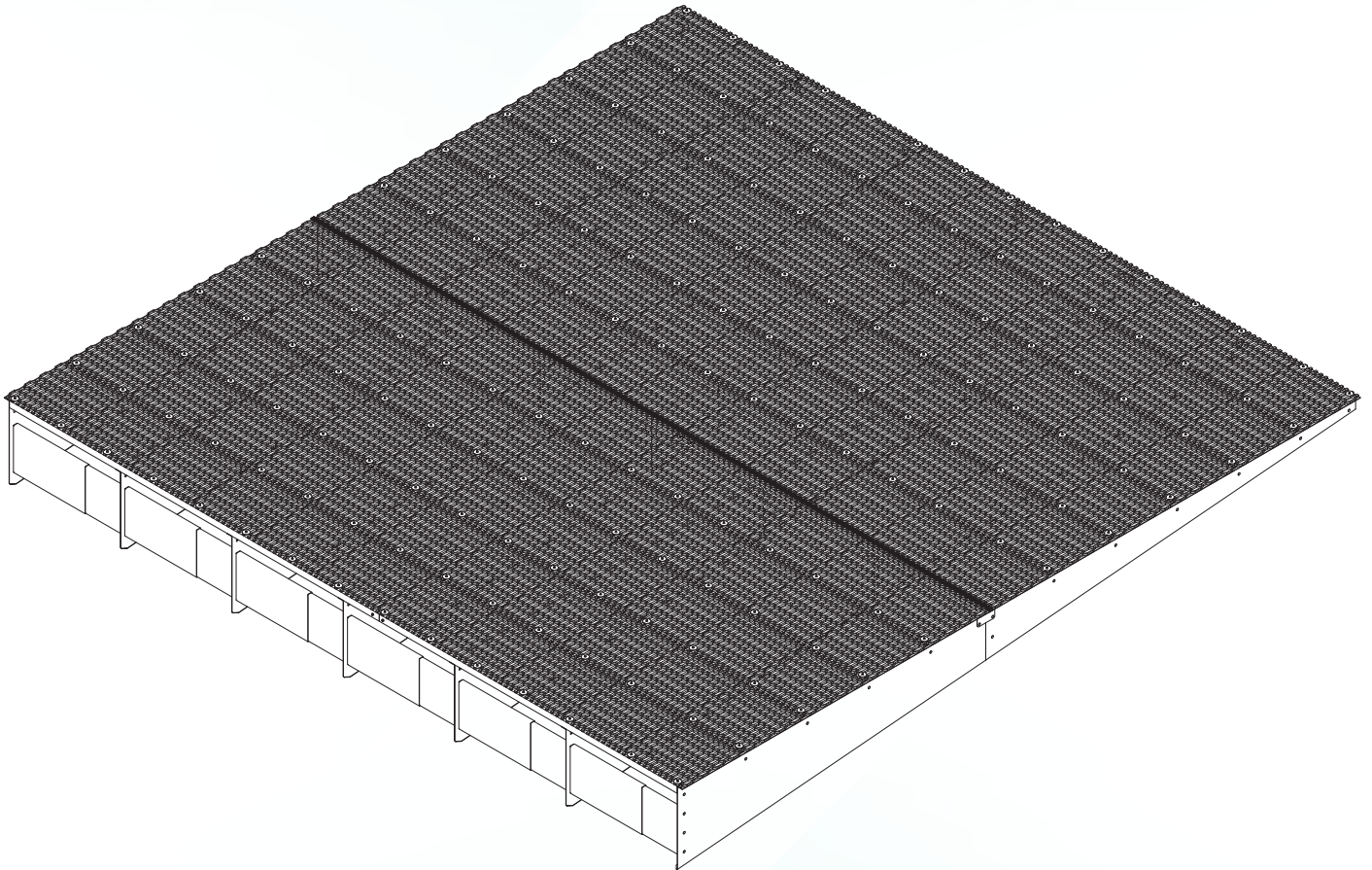
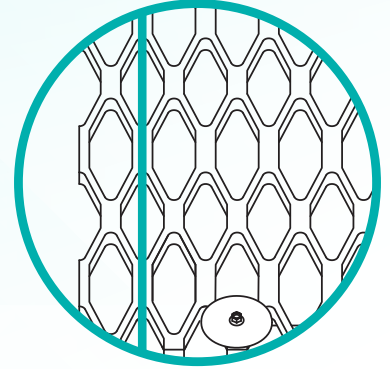
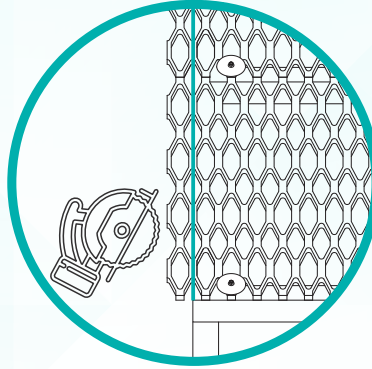

## Assembly description

**21.** If the last sheet of **Mesh** is overhanging the **End Beam Wedge** by more than 25mm then cut off the overhanging **Mesh** through the relevant joins in the diamonds.

22

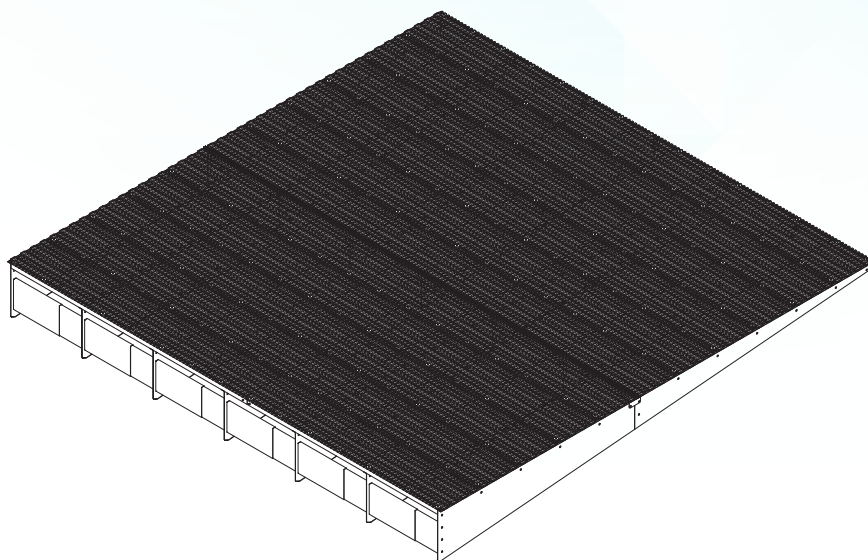

## Parts required



Mesh Sheet

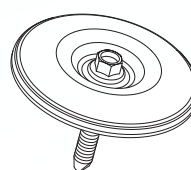

35mm **Tek Screw**  
Hold Down **Disc**

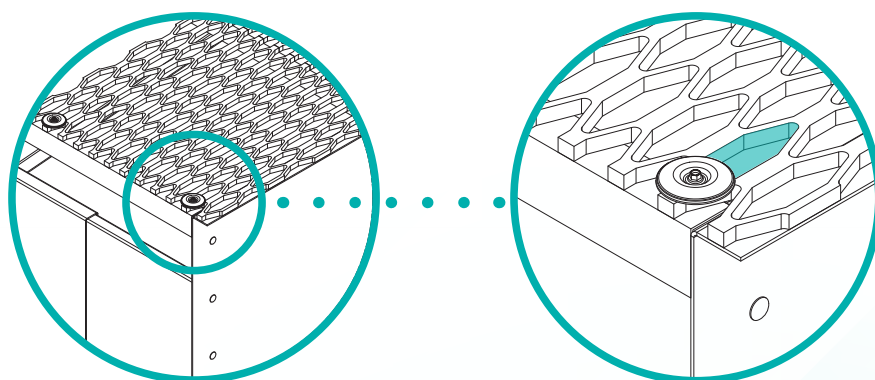

## Assembly description

**22.** Fix down all the sheets of **Mesh** using a **35mm Tek Screw and a Hold Down Disc** in the second full diamond in from the edge of the sheet of Mesh, where each sheet of Mesh crosses each of the Cross Supports.

23

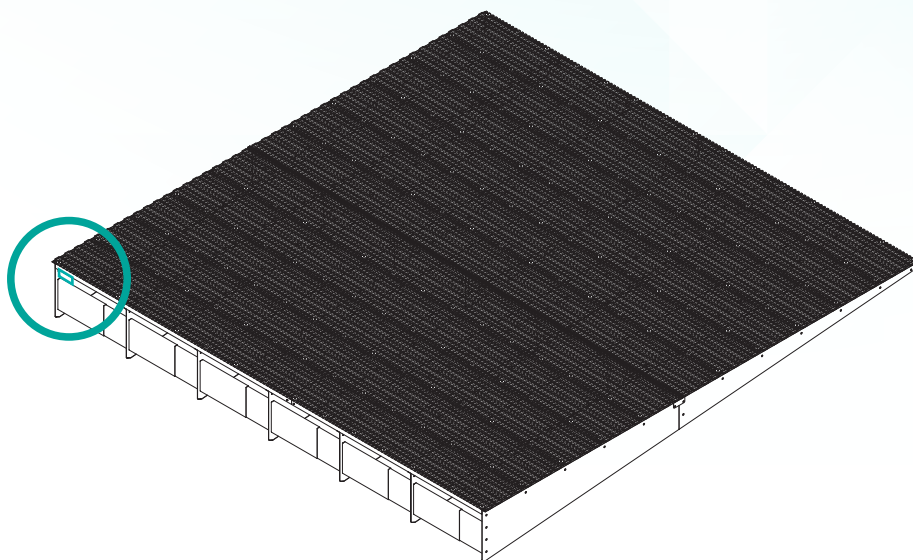

## Parts required



**Certification Plate**

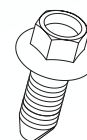

**16mm Tek Screws**



## Assembly description

**23.** Fix the **Certification Plate** to one of the **Cross Supports** where it can be seen using **16mm Tek Screws**.



24

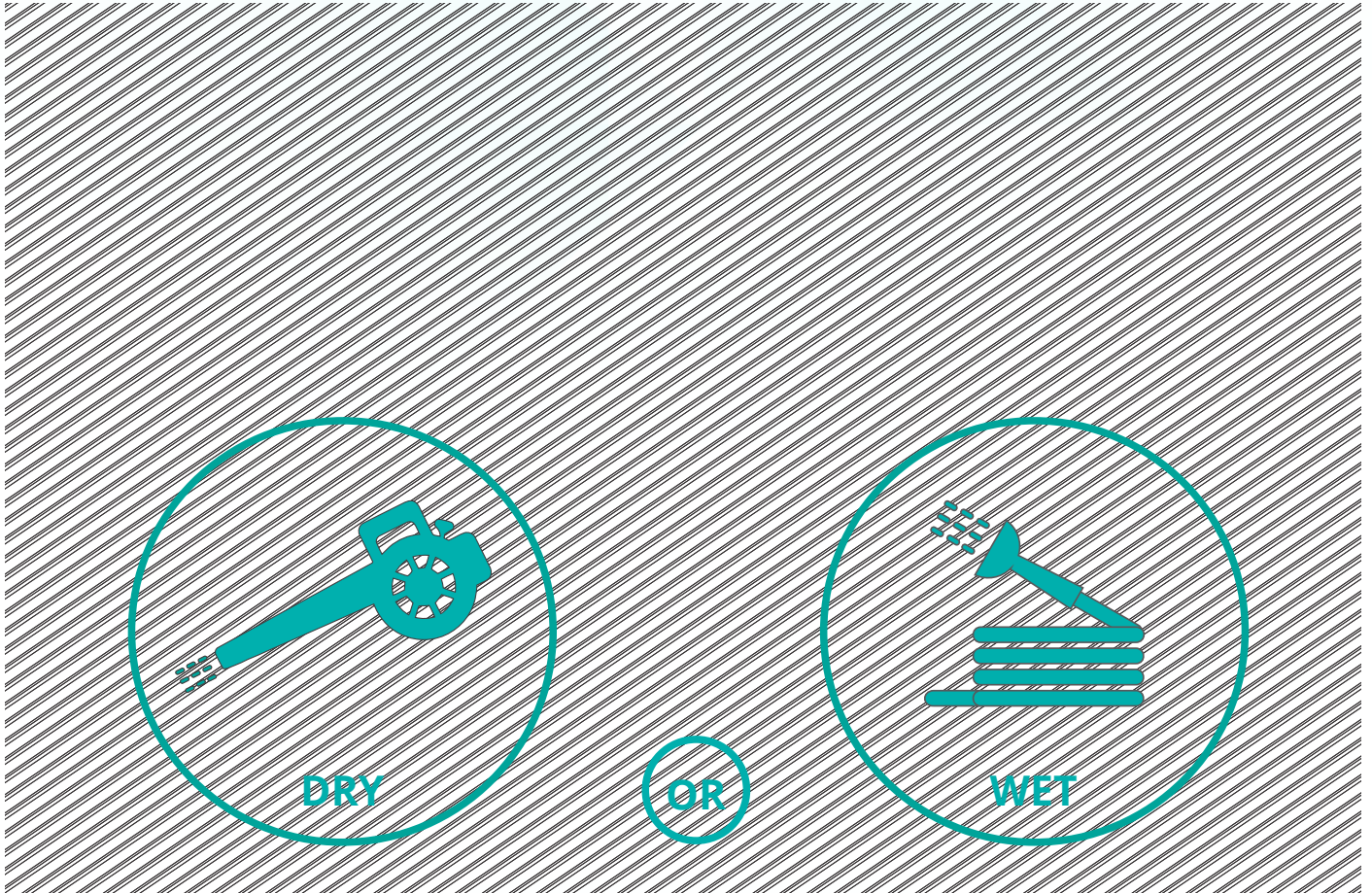

### **Assembly** description

**24.** Clean the roof down well with a petrol blower if the roof is dry and a hose if the roof is wet.





---

[www.con-formgroup.com.au](http://www.con-formgroup.com.au)



ABN 99 768 968 429